

12" LEG VERSION
P/N: 1750000N

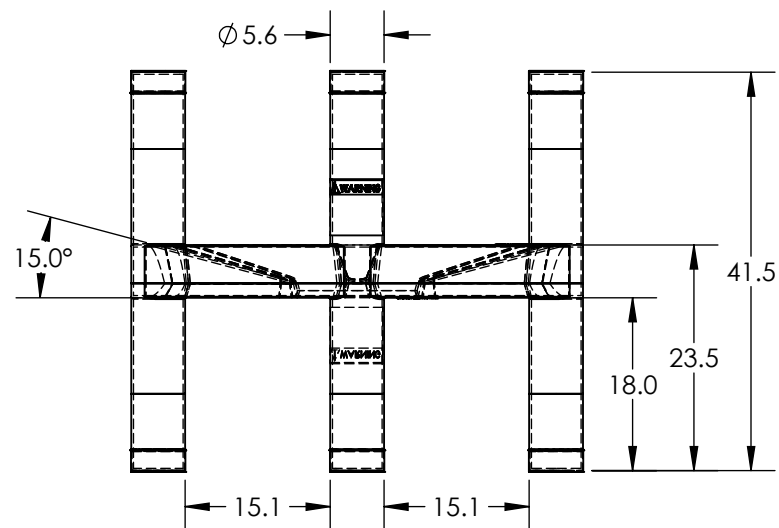

18" LEG VERSION
P/N: 1750001N

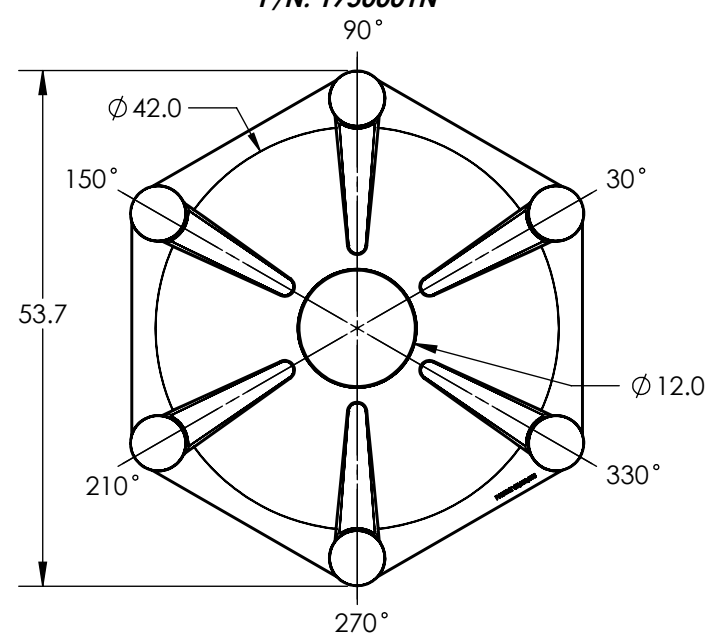
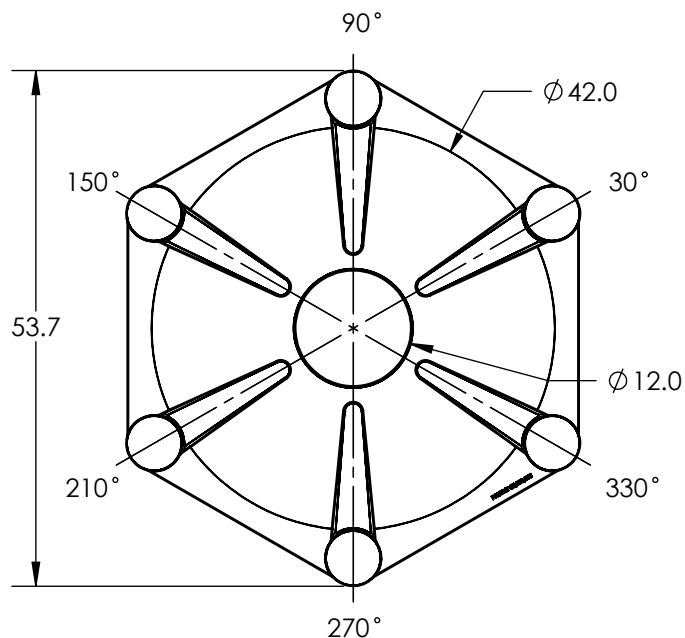

***ALL EXTERNAL PIPING MUST BE INDEPENDENTLY SUPPORTED.**
***ONLY BASE FITTINGS TO BE LEFT INSTALLED AT TIME OF SHIPMENT PER SII PROCEDURE.**
***Consult Snyder's Guidelines for Use and Installation prior to delivery.**
 Available on-line at <http://www.snyderindustriestanks.com/Technical>
ALL DIMENSIONS ARE IN INCHES, NOMINAL, & SUBJECT TO CHANGE WITHOUT NOTICE.
ALL DIMENSIONS ON ROTATIONAL MOLDED PARTS ARE SUBJECT TO A ± 3% TOLERANCE.

DO NOT SCALE		DRAWN BY	DATE	 SNYDER INDUSTRIES, INC. 4700 Fremont Street Lincoln, NE 68504 (402) 467-5221 www.snyder.net.com	TITLE:	ASM STAND FLAT/CONE 42 DIA.		REVISION
STATUS:	Released	ET3	07/07/2014		A			
© SNYDER INDUSTRIES INC., 2014								SHEET 1 OF 1
ALL DIMENSIONS, DESIGNS, AND INFORMATION ON THIS PRINT MUST BE CONSIDERED PROPRIETARY TO SNYDER INDUSTRIES, INC. AND MAY NOT BE USED, COPIED, OR DISTRIBUTED WITHOUT WRITTEN PERMISSION OF AN OFFICER (OR HIS AGENT) OF THE FIRM.					PART NO.	12"=1750000N 18"=1750001N	ENG. ID.	D002333

SHEET
1 OF 1