

6" RISER  
P/N 34300028

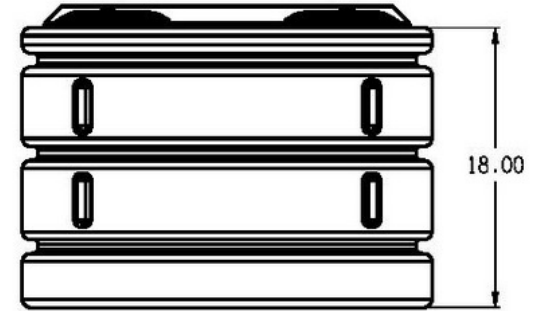

12" RISER  
P/N 34300029



18" RISER  
P/N 34300030

FEATURES:  
 FULL 20" ACCESS.  
 RIBBED DESIGN FOR INCREASED STRUCTURAL CAPACITY.  
 SII PATENTED LOCKING LUG INTERFACE AT THE TOP AND BOTTOM OF RISERS.  
 MATES WITH ALL SII SEPTIC AND CISTERN TANKS AND SII DOUBLE WALL LID  
 MATERIAL MEETS FDA REQUIREMENTS [21 CFR 177.1520] FOR FOOD CONTACT.

(all dimensions in inches)

PART #:	6" RISER	34300028
	12" RISER	34300029
	18" RISER	34300030
REF#:	0000	02/18/08

## 6, 12", & 18" SEPTIC/CISTERN RISERS